

Build Kansas Fund | Fiscal Year 2026 Application Package | Memo



To: Senator Rick Billinger, Chair, Build Kansas Advisory Committee
Chardae Caine, Kansas Legislative Research Department
Shauna Wake, Office of the Kansas State Treasurer

From: Jason Fizell, Interim Executive Director, Kansas Infrastructure Hub

RE: Build Kansas Fund Application #2025-157-SCKEDD

Date: July 22, 2025

Attached, please find an application made to the Build Kansas Fund by Cowley County. The application packet includes the following items:

- Coversheet – provides a high-level overview of the application including a unique identification number, page 1 of 12 of the Build Kansas Fund Application Package.
- Build Kansas Fund Application – includes information submitted with the Build Kansas Fund Application, pages 2-8. Page 8 provides the table of funding sources and zip codes served by the project.
- Attachments – Executive summary and project map images, pages 9-12.

Project Overview

Cowley County seeks funding from the U.S. Department of Transportation for funding available through the Safe Streets and Roads for All (SS4A) program for their Cowley County Dexter Y Intersection Realignment project which includes realigning the intersection of K-15 and 162nd Road to a safer T-intersection configuration to improve sight distance, reduce vehicle speeds, and prevent serious crashes.

This opportunity is a discretionary IIJA program with a local match requirement of 20% of the total project cost. The entity is requesting \$365,433.40 from the Build Kansas Fund, and is providing a local match of \$19,233.34. This request has the potential to unlock \$1,538,666.96 in federal funds, for a total project cost of \$1,923,333.70.

The deadline was June 26, 2025, and this Build Kansas Fund application was received on June 18, 2025.

Build Kansas Fund Steering Committee Recommendation

The Build Kansas Fund Steering Committee reviewed this application on June 25, 2025 following a successful completeness check. The Steering Committee **RECOMMENDS APPROVAL** of Build Kansas Funding to the Build Kansas Advisory Committee for final advice.

Build Kansas Fund | Fiscal Year 2026

Application Package | Coversheet



Build Kansas Fund Application Number	2025-157-SCKEDD
Applicant Name	Cowley County
Application Date Received	6/18/2025
Project Name	Cowley County Dexter Y Intersection Realignment Project
Project Description	Realign the intersection of K-15 and 162 nd Rd to a safer T-intersection configuration to improve sight distance, reduce vehicle speeds, and prevent serious crashes
Entity Type	County Government
Economic Development District (EDD) Planning Commission	South Central KS Economic Development District
Infrastructure Sector(s)	Transportation
BIL Program	Safe Streets and Roads for All (SS4A) Program
BIL Program Type	Discretionary
Application Type	Implementation
BIL Application Deadline	6/26/2025
Build Kansas Fund Request	\$365,433.40
Technical Assistance Received	General Yes <input checked="" type="checkbox"/> No <input type="checkbox"/>
	BIL Application Yes <input type="checkbox"/> No <input checked="" type="checkbox"/>
	Build Kansas Fund Application Yes <input checked="" type="checkbox"/> No <input type="checkbox"/>
	Other (Brief Description): Provided General TA and BKF Application Support.
Application Notes	Build Kansas Fund contribution of \$365,433.40 will unlock \$1,538,666.96 in federal BIL funding, with a local cash contribution of \$19,233.34 for a total project cost of \$1,923,333.70.
Steering Committee Funding Recommendation	6/25/2025 Recommend <input checked="" type="checkbox"/> Declined <input type="checkbox"/>
Advisory Committee Funding Recommendation	7/22/2025 Recommend <input type="checkbox"/> Declined <input type="checkbox"/>

Title	COWLEY COUNTY	06/18/2025
	by Jon Jordan in Build Kansas Fund Application	id. 50860299
	jjjordan@cowleycountyks.gov	

Original Submission	06/20/2025
----------------------------	------------

Score	n/a
-------	-----

Part 1: Applicant Information

The name of the entity applying for the Build Kansas Fund:	COWLEY COUNTY
--	---------------

Project Name:	COWLEY COUNTY DEXTER Y INTERSECTION REALIGNMENT PROJECT
---------------	---

Entity type:	County Government
--------------	-------------------

Entity Population:	34,186
--------------------	--------

Applicant Contact Name:	JON JORDAN
-------------------------	------------

Applicant Contact Position/Title:	PUBLIC WORKS SUPERINTENDENT
-----------------------------------	-----------------------------

Applicant Contact Telephone Number:	+16202215425
-------------------------------------	--------------

Applicant Contact Email Address:	jjjordan@cowleycountyks.gov
----------------------------------	-----------------------------

Applicant Contact Address:	311 E 9TH AVE, SUITE 104
----------------------------	--------------------------

Applicant Contact Address Line 2 (optional):	
--	--

Applicant Contact City:	Winfield
-------------------------	----------

Applicant Contact State:	Kansas
--------------------------	--------

Applicant Contact Zip Code:	67156
-----------------------------	-------

Is the Project
Contact the same as
the Applicant
Contact?

Yes

Part 2: Build Kansas Fund - Eligibility Criteria

Certify that you are
pursuing an
Infrastructure
Investment and Jobs
Act (IIJA) funding
opportunity for which
your entity is eligible:

Yes

Certify that the
Infrastructure
Investment and Jobs
Act (IIJA) funding
opportunity you are
pursuing has a
required non-federal
match component:

Yes

What is the primary
county that the
project will occur in?

Cowley County

The Build Kansas Fund is intended to support Kansas-based infrastructure projects. Please provide a list of all the zip codes this project will be located in, along with an estimated percent [%] of the project located in that zip code. For example, if seeking funding for road infrastructure, provide a rough percent of the roads expected in each zip code:

[Zip Code Percentage.xlsx](#)

Part 3: Infrastructure Investment and Jobs Act (IIJA) - Grant Application
Information Please Note: This information is related to the federal
Infrastructure Investment and Jobs Act (IIJA) funding opportunity to which
you will apply. This is NOT information for the Build Kansas Match Fund.

Please enter the
Infrastructure
Investment and Jobs
Act (IIJA) funding
opportunity title that
the entity is applying
for:

DOT-SS4A-FY25-01

What is the funding
agency for this
Infrastructure
Investment and Jobs
Act (IIJA) funding
opportunity?

U.S. Department of Transportation

What is the Assistance Listing Number (ALN) for this Infrastructure Investment and Jobs Act (IIJA) funding opportunity?	20.939
What is the federal application due date for this Infrastructure Investment and Jobs Act (IIJA) funding opportunity?	6/26/2025
Application Type:	Implementation
What is the federal fiscal year for this Infrastructure Investment and Jobs Act (IIJA) funding opportunity?	2025
Enter the amount of funding being applied for, from the Infrastructure Investment and Jobs Act (IIJA) funding opportunity:	\$1,538,666.96 for a total project cost of \$1,923,333.70
Enter the total project cost:	\$1,923,333.70
Enter the required non-federal match percentage:	20%
<p>Part 4: Build Kansas Fund - Match Application Information Beginning in July 2024 and moving forward, eligible applicants are expected to contribute a portion of the non-Federal match requirement. This contribution can be in the form of cash and/or in-kind contributions. The goal is to demonstrate the applicant's commitment to the project. The contribution should be significant enough relative to the Build Kansas Fund request. For a local public entity, 5% of the non-federal match is a good guideline, but not a requirement. See Build Kansas Fund Program Guidance for exceptions and more information.</p>	

Enter the non-federal cash match amount being requested from the Build Kansas Fund: \$365,433.40 for a total project cost of \$1,923,333.70

Enter the non-federal cash match amount being provided by the eligible applicant, if applicable: \$19,233.34 for a total project cost of \$1,923,333.70

Enter the estimated value of the non-federal in-kind match amount being provided by the eligible applicant, if applicable: 0

Expected breakdown of funding sources to support the project: Enter the funding source and projected amount from each source to support this project:

[Kansas+DOT+table_V2.xlsx](#)

Part 5: Build Kansas Fund - Means Test and Eligible Applicant Match

What other available funding sources that are currently planned to go unused by your entity will be leveraged for this project? N/A

Will any American Rescue Plan Act (ARPA) or Coronavirus State & Local Fiscal Recovery Fund monies will be used for the non-federal match? N/A

What other sources of in-kind match will be leveraged for this project? Please list and include the actual or estimated value of each. N/A

What other funding sources (local, federal, or non-federal) will be used for this match?

N/A

Describe your efforts to find other available funding sources for this project:

Funding from HRRR was sought but not chosen for this project.

Part 6: Additional Information

Please upload a draft or final version of the Infrastructure Investment and Jobs Act (IIJA) program grant application associated with this request OR an executive summary providing an overview of the project:

[Form-SF-424_SS4A.pdf](#)

[Form-SF-424C_SS4A.pdf](#)

[Form-SF-LLL_SS4A.pdf](#)

[SS4A_FY25-Self-Certification-Worksheet.pdf](#)

[Cowley_SS4A_Implementation_Grant_-_Narrative.pdf](#)

Provide any additional information about this project not covered in previous sections of this application (optional):

Part 7: Terms and Conditions

Understanding of Fund Release Requirements:

checked

Understanding of Use of Funds:

checked

Understanding of Reporting Requirements:

checked

Authority to Make Grant Application:

checked

Persons and Titles: Jon
The following Jordan
persons are
responsible for
making this Build
Kansas Fund
application.

Position/Title: Public Works Superintendent

Additional: Lucas
Goff

Position/Title: County Administrator

Additional: John
Riggins

Position/Title: County Engineer

Additional:

Position/Title:

Source	Amount	% of Project
Build Kansas Funds (non-federal match)	\$365,433.40	19.00%
Eligible Applicant Cash Match	\$19,233.34	1.00%
Eligible Applicant In-Kind Match (estimated value)	\$0.00	0%
BIL Federal Funds (applied for)	\$1,538,667.00	80.00%
Additional Project Contribution (if applicable)	\$0.00	0%
TOTAL PROJECT COST	\$1,923,333.74	100%

***Applicant satisfies recommended match contribution of 5% of the required match**

Zip Code	% of project in zip code
67038	98%
67019	1%
67023	1%
	100% In Kansas

Overview

Cowley County, Kansas submits this application under the opportunity Safe Streets and Roads for All (SS4A) discretionary program. If successful, this application will allow Cowley County, Kansas to implement one of the projects identified in the recently completed action plan.

Cowley County has a population of just under 35,000 located in south central Kansas. It is a county/township government so the county will partner with the township on roads that are within the county but maintained by townships. As evident by the population, the county is rural with a sizable portion of the workforce having occupations related to farming, ranching, and oil fields. There are 310 miles of paved roads, 1,241 miles of gravel or dirt roads and 257 bridge-length structures maintained by Cowley County.

Location

The project will be located approximately twelve miles east of Winfield, Kansas at the intersection of K-15 and Cowley County 162nd Road.

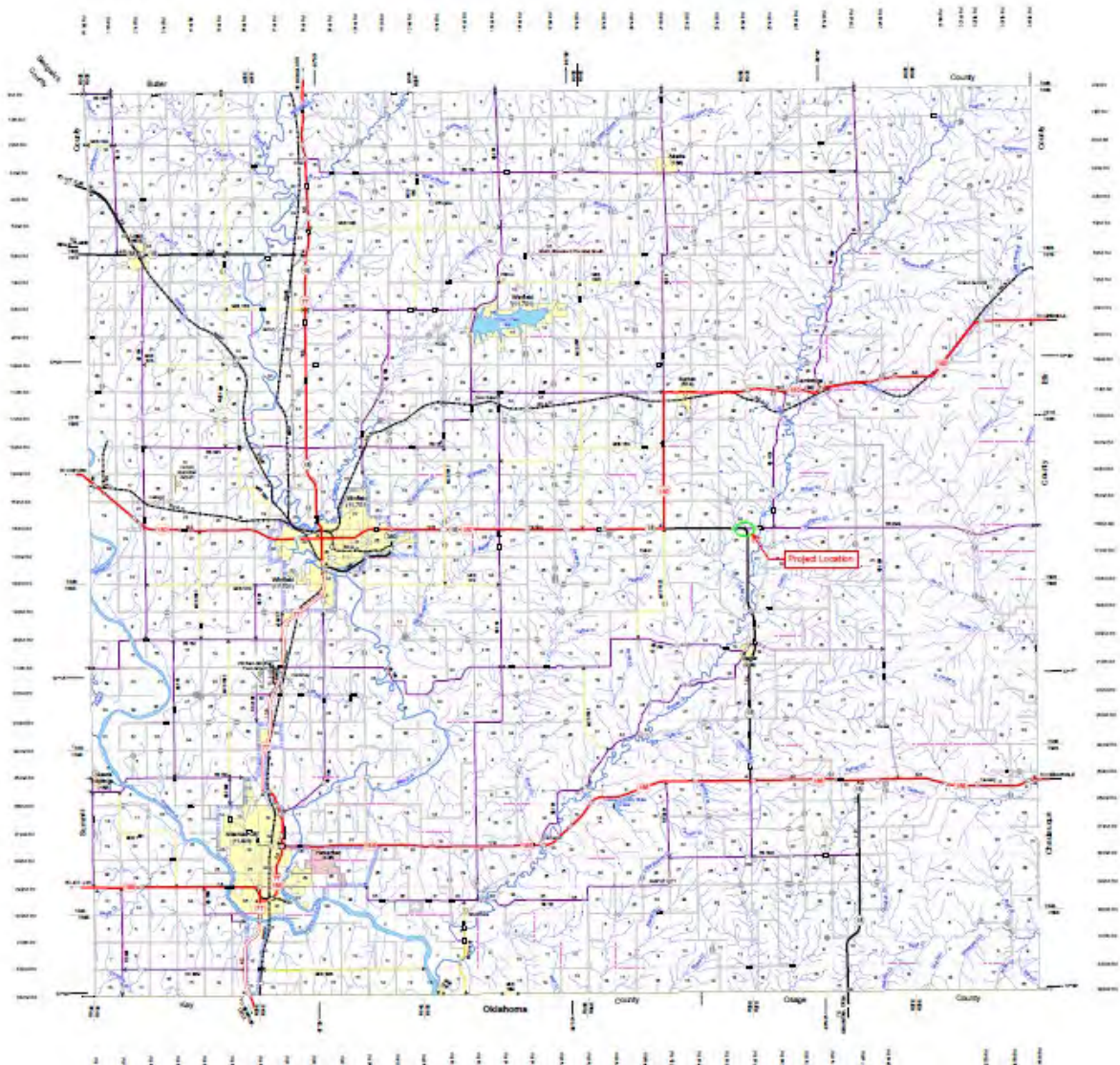

Expanded Project Location

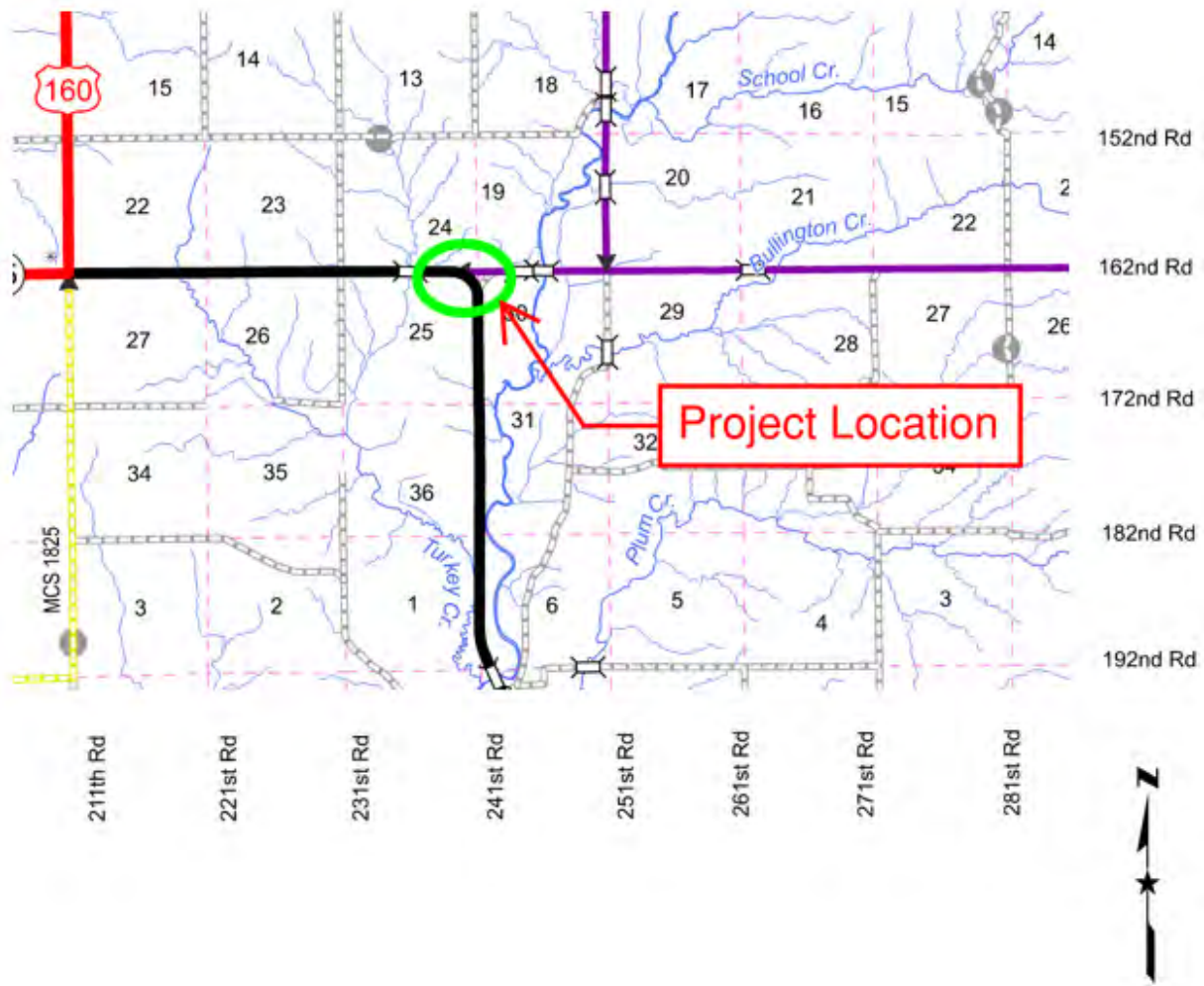

Detailed Project Location

The State of Kansas maintains K -15 while 162nd Road is owned by Cowley County, Kansas. Both are paved routes with significant truck traffic on both routes. The ADT for this intersection is 481 vehicles per day, with 10.6% of those vehicles considered large. The average speed of vehicles entering K-15 from 162nd Road is 65.2 mph, so it is evident that most vehicles are not even slowing down before going through the intersection.

Project Scope

The proposed countermeasure is to remove the existing legs of 162nd Road to connect to K-15 further south & realign the intersection to a "T" configuration. By moving the intersection to the south of the current location, it eliminates the need to remove thousands of cubic yards of bedrock and move the intersection south of the curve on K-15 instead of having the intersection in the middle of the curve. The new roadway will be 24-ft wide with center and edge lines. The eastern project limit will be the end of wearing surface of Cowley Co Bridge FAS 99. The improvements would include full depth asphalt pavement, aggregate base, grading, signing, & pavement markings.

Response to Selection Criteria

Safety Need

The corridor on 162nd Road between K-15 and 251st Road was identified as a top ten location for safety improvements in the Local Road Safety Plan and as potential project in Cowley County's SS4A Action Plan. The county intends to use this Implementation Grant to realign the intersection of K-15 and 162nd Road to resolve sight-distance issues. The existing intersection at 162nd Road (RS 2049) & K-15 has poor sight conditions for traffic entering and exiting on to K-15 from 162nd road, and the super-elevation for the existing curves does not meet the current AASHTO requirements. At this location, K-15 curves to the south and 162nd Rd intersects K-15 from the east. The current intersection is a Y configuration with a massive rock outcropping in the middle of the Y that limits the sight distance for vehicles attempting to enter onto K-15. When trucks enter K-15 from 162nd Road, it takes a lot of time for them to get up to driving speed and create numerous near collisions between the traffic from the two roads.

The County receives multiple complaints and reports of near accidents at this intersection every year. Most of the accidents have been limited to simple roadway departures or minor property damage thus far but there is justified concern that it is only a matter of time until a major collision takes place at this intersection unless improvements are made.

This intersection provides a connection from the City of Winfield to Chautauqua County and this project would be considered the final improvement along the corridor that the county has invested \$5 million in bridge improvements funded through geo bonds and \$170,000 in roadway improvements over the past 3 years.

Safety Impact

The most significant safety impact will be to realign the intersection so that the roads intersect at a ninety (90) degree angle, thus improving the sign distance for vehicles entering onto K-15. By requiring vehicles to turn onto 162nd Road, it will significantly reduce the average speed through the intersection. Added countermeasures such as enhanced stop signs (0.9 CMF), safety edge treatments (0.79 CMF) and rumble strips (0.53 CMF) will be incorporated into the project.

Engagement and Collaboration

Traffic studies from as far back as 1997 and as recently as 2013 have been performed for this intersection so it is evident that this intersection has been identified as an area of concern for almost 30 years. The above noted bridge projects have removed weight limitations from the structures and there is a quarry located just across the Cowley/Chautauqua County line to the east. This has resulted in increased the volume of large loads that utilize this corridor and, in turn, increased the number of potential accidents.

Funding from this SS4A Implementation Grant will enable Cowley County to address their highest priority project to improve safety of the traveling public. Cowley County recently attempted to secure funding assistance for this project from the Kansas Department of Transportation, but the project was not selected. The total estimated project cost represents approximately 56% of Cowley County's entire operational annual budget for road and bridges. If the county were to attempt to fund the project locally, it would take almost 6 years of cutting the operational budget by 10% to save enough money for just this project.

Cowley County has had several discussions over the past year with the Kansas Department of Transportation (KDOT) about this specific project. The most recent communication was KDOT approving a request from Cowley County to have a Traffic Engineering Assistance Program (TEAP) study performed. The final report from the study anticipated to be received in the next 3-6 months. Cowley County has involved the KDOT Area Engineer in Winfield, KDOT Bureau of Local Projects, and one of their Transportation Safety Planners in discussions related to this project.

Project Readiness

It is estimated that the project can be ready for letting within 18 months of issuing the design notice to proceed. Construction is anticipated to take 4-6 months. Even if a large window is allowed for the time between letting and start of construction, the total time from design notice to proceed to completion of construction is estimated to be less than 3 years. Below are the estimated milestones for the project:

Notification of Selection from FHWA	September, 2025
Design Firm Selection	November, 2025
Preliminary Survey	February, 2026
Field Check Meeting	August, 2026
NEPA Review Complete	October, 2026
R/W Acquisition Complete	November, 2026
Final Design Complete	December, 2026
Utility Relocations Complete	January, 2027
Project Letting	January, 2027
Construction Start	June, 2027
Construction Complete	November, 2027